

# PROGRAMME IMMOBILIER IMMEUBLE R+3 A NGAPAROU SENEGAL



2018

# APPARTEMENT TYPE G1

## REZ-DE-CHAUSSEE

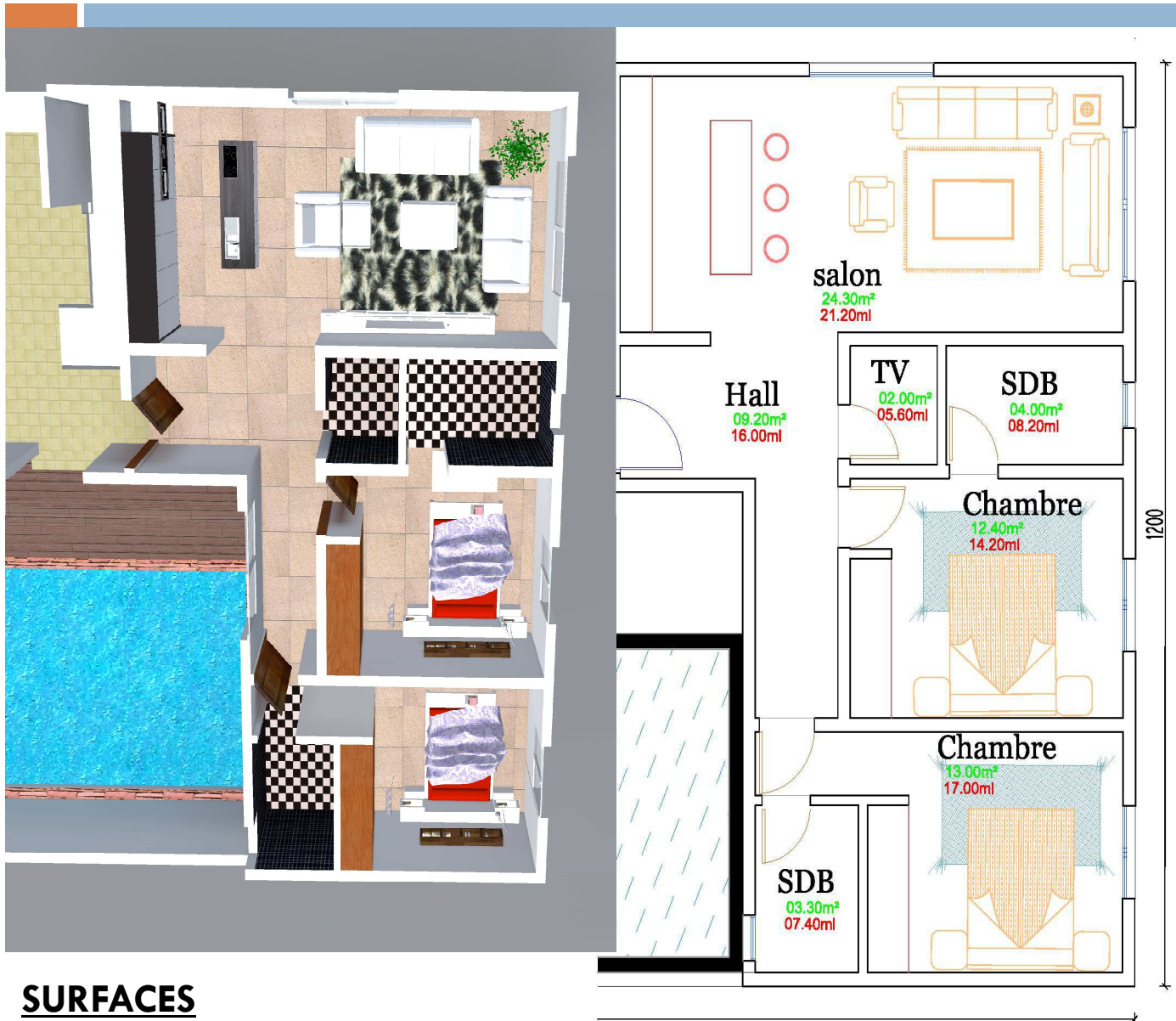

### SURFACES

**SALON.....24.3 m2**

**HALL.....9.20 m2**

**CHAMBRE1.....12.40m2**

**CHAMBRE PRINCIPALE.....13m2**

**LOCAUX HUMIDES.....9.30m2**

**TOTALE SURFACE UTILE.....68.2 m2**

**PRIX 20 000 000 FCFA**

# APPARTEMENT TYPE G2 et D



**PRIX 20 000 000 FCFA**

# APPARTEMENT TYPE G2 et D

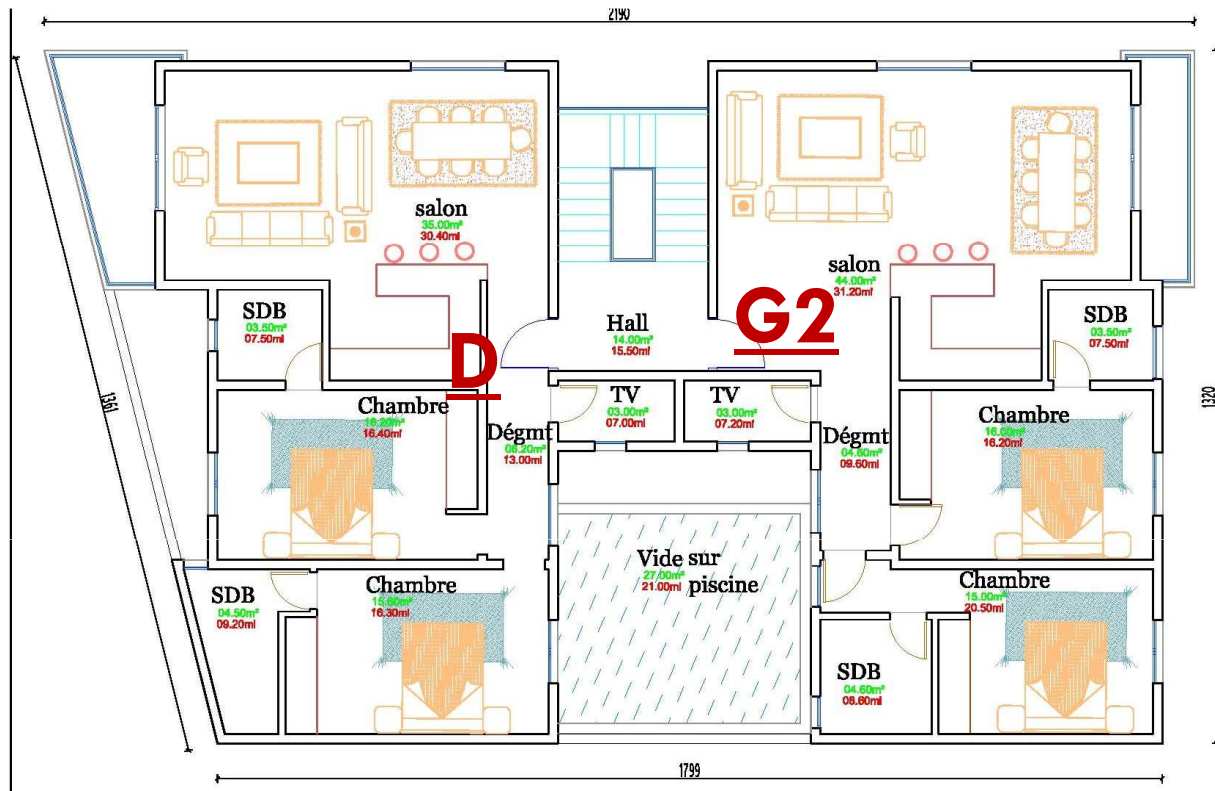

## TYPE D

### SURFACES

SALON.....35 m2  
DEGAGEMENT.....6.20 m2  
CHAMBRE1.....15.60m2  
CHAMBRE PRINCIPALE.16.20m2  
LOCAUX HUMIDES.....11m2  
TOTALE SURFACE UTILE...84 m2

## TYPE D

### SURFACES

SALON.....44 m2  
DEGAGEMENT.....4.60 m2  
CHAMBRE1.....15.m2  
CHAMBRE PRINCIPALE .16m2  
LOCAUX HUMIDES...11.10m2  
TOTALE SURFACE UTILE....90.7 m2

**PRIX 20 000 000 FCFA**

# PLAN PROJET REZ-DE-CHAUSSEE

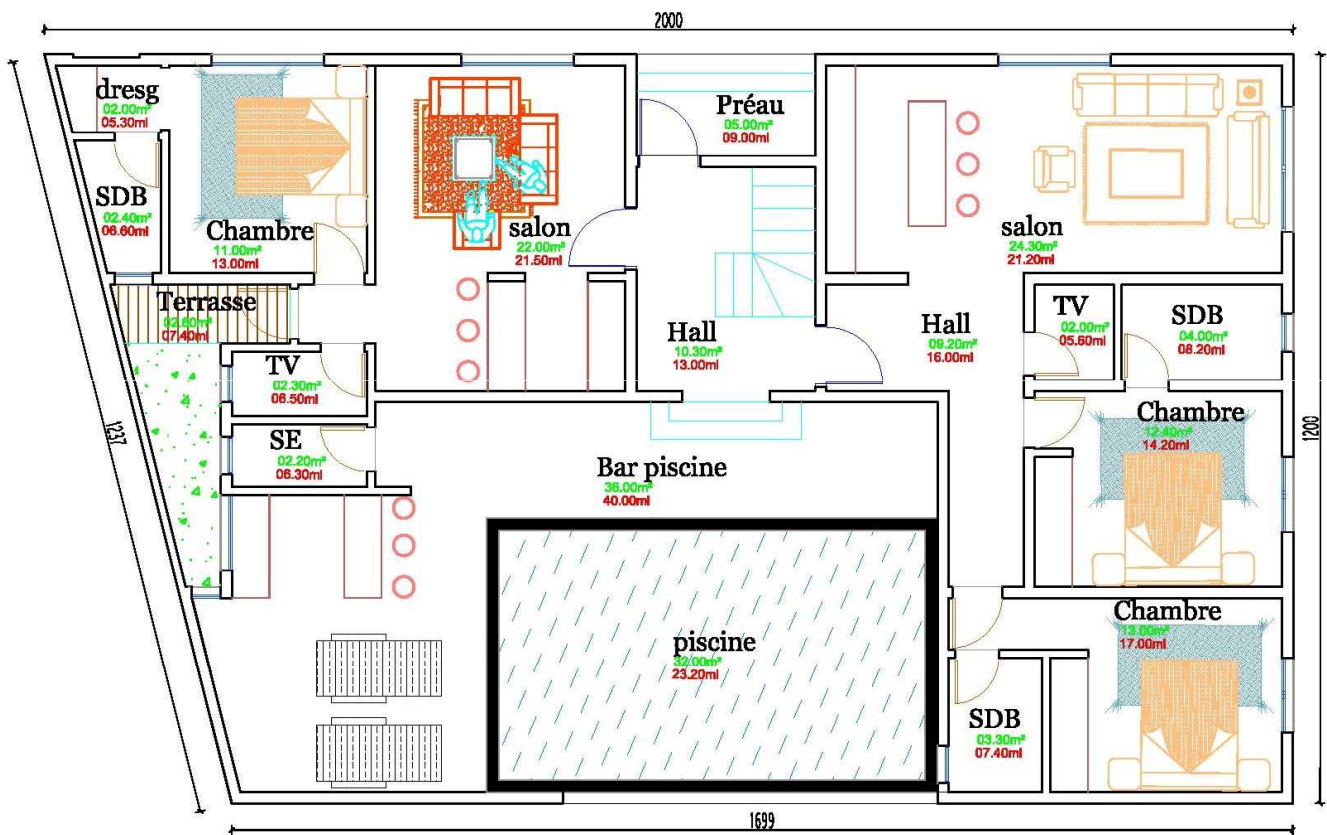

# PLAN PROJET ETAGES COURANT

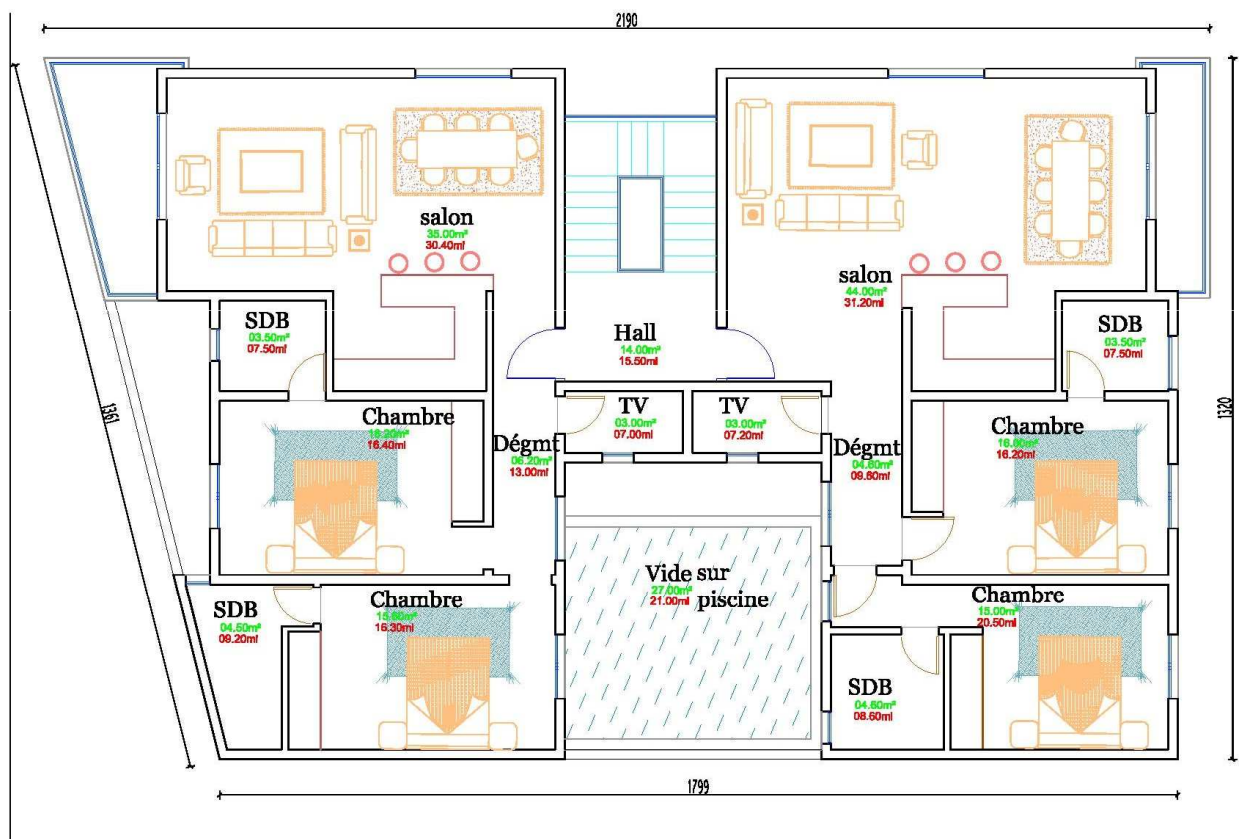

# FACADE PROJET

